

Rollerball & Fountain Pen

Mandrel #21914
 Bushing #21893
 Drill V #21886

TURNING INSTRUCTIONS-CAP METHOD #1

1. CUT WOOD LENGTH OF TUBE.
2. DRILL WITH V BIT AND GLUE IN TUBE.
3. TURN TO DEPTH COLLARS (YOU CAN SAND & POLISH BEFORE OF AFTER STEP 4. WITH PARTING TOOL PART OFF 1/8 INCH OF WOOD TO BRASS TUBE-LEAVING AT LEAST 1 7/8 INCHES OF WOOD LEFT.
5. SAND & GLUE OFF OF EXPOSED TUBE.
6. USE BUSHING 1-2 FOR THIS METHOD.

TURNING INSTRUCTIONS-CAP METHOD #2

1. CUT WOOD AT LEAST 1 7/8.
2. DRILL WITH V BIT & GLUE IN TUBE. THIS SHOULD LEAVE YOU WITH PART OF TUBE EXPOSED, BUSHING #3 WILL COVER TUBE.
3. TURN TO DEPTH COLLARS & POLISH.
4. USE BUSHING 1-2-3 FOR THIS METHOD LOWER BARREL-SAME FOR METHOD #1 & #2.

CUT WOOD LENGTH OF TUBE OR A LITTLE LONGER TO SQUARE OFF.
 TURN TO DEPTH COLLARS #4-5.
 SAND & POLISH.

ASSEMBLY FOR CAP

1. ASSEMBLE 3 PIECE CENTER RING AND PRESS ON EXPOSED TUBE.
2. PRESS IN BRASS CLIP BUSHING.
3. PUT FINIAL THROUGH HOLE IN CLIP & THREAD INTO BRASS CLIP BUSHING.

ASSEMBLY FOR LOWER BARREL

1. PRESS NIB HOLDER INTO ONE END OF FINISHED BARREL.
2. PRESS REDUCER COUPLER INTO OTHER END.
3. PRESS ON BLACK TUBE.
4. PRESS IN FINIAL (NOT TOO HARD, IT WILL SPREAD OUT THE BLACK TUBE AND WILL NOT FIT INTO CAP).
5. DROP IN SMALL SPRING LITTLE END UP (ROLLER BALL ONLY).
6. ROLLER BALL ONLY-PUT IN INK INFILL & SCREW NIB INTO NIB HOLDER.
7. FOUNTAIN PEN ONLY-INSERT CARTRIDGE OR INK PUMP INTO FOUNTAIN PEN NIB & SCREW INTO NIB HOLDER (USE ONE OR THE OTHER).

HINTS-FILLING INK PUMP

1. REMOVE FROM NIB AND SCREW PUMP ALL THE WAY DOWN.
2. PUT IN BOTTLE OF INK THEN TWIST PUMP END TO FILL

HINTS-CAP

1. TOO MUCH TUBE EXPOSED WILL KEEP CAP FROM SCREWING ALL THE WAY ON.
2. LEAVING CAP OFF THIS UNIT WILL CAUSE LEAKAGE OR THE INK TO DRY UP.

ROLLER BALL REFILLS:

SHAEFFER SLIM ROLLER BALL REFILL
 CROSS ROLLING BALL REFILL FOR SELECTIP® PEN
 CROSS POROUS POINT REFILL FOR SELECTIP® PEN

11-99

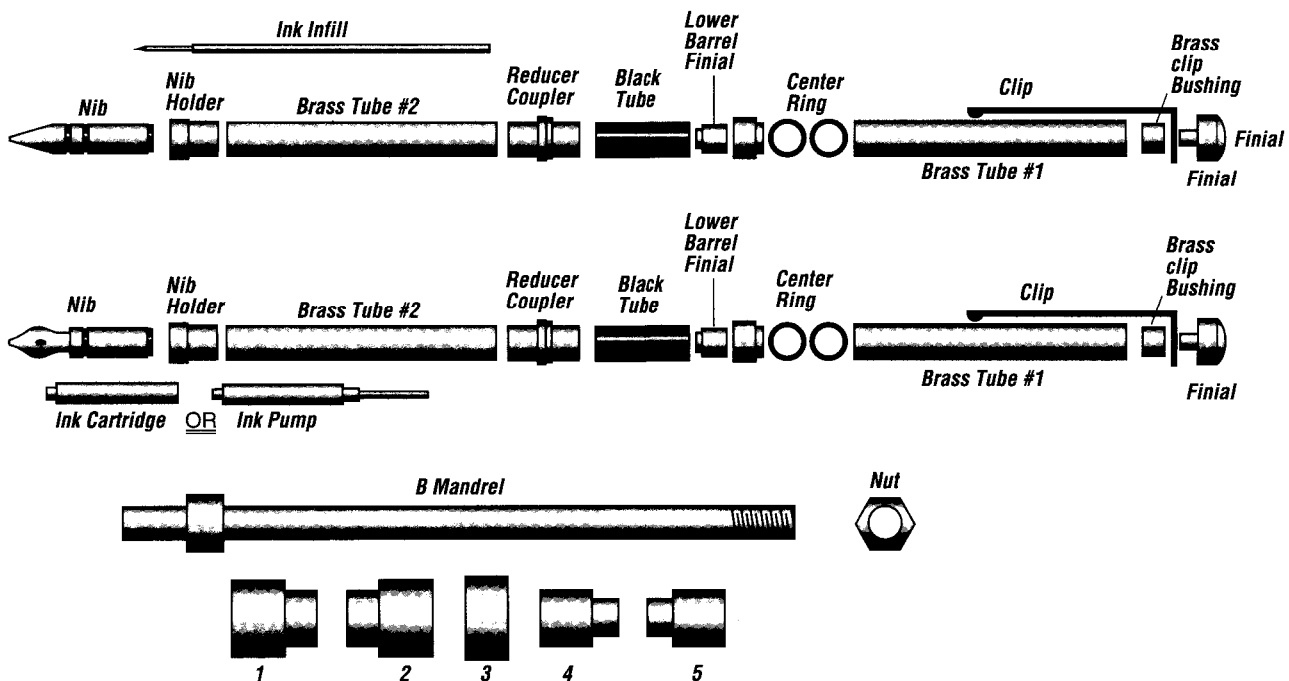

26679
 61299
 61307

ROCKLER®
 WOODWORKING AND HARDWARE

© Rockler Companies Inc. 2002

RTD10000299AB