

Tray components

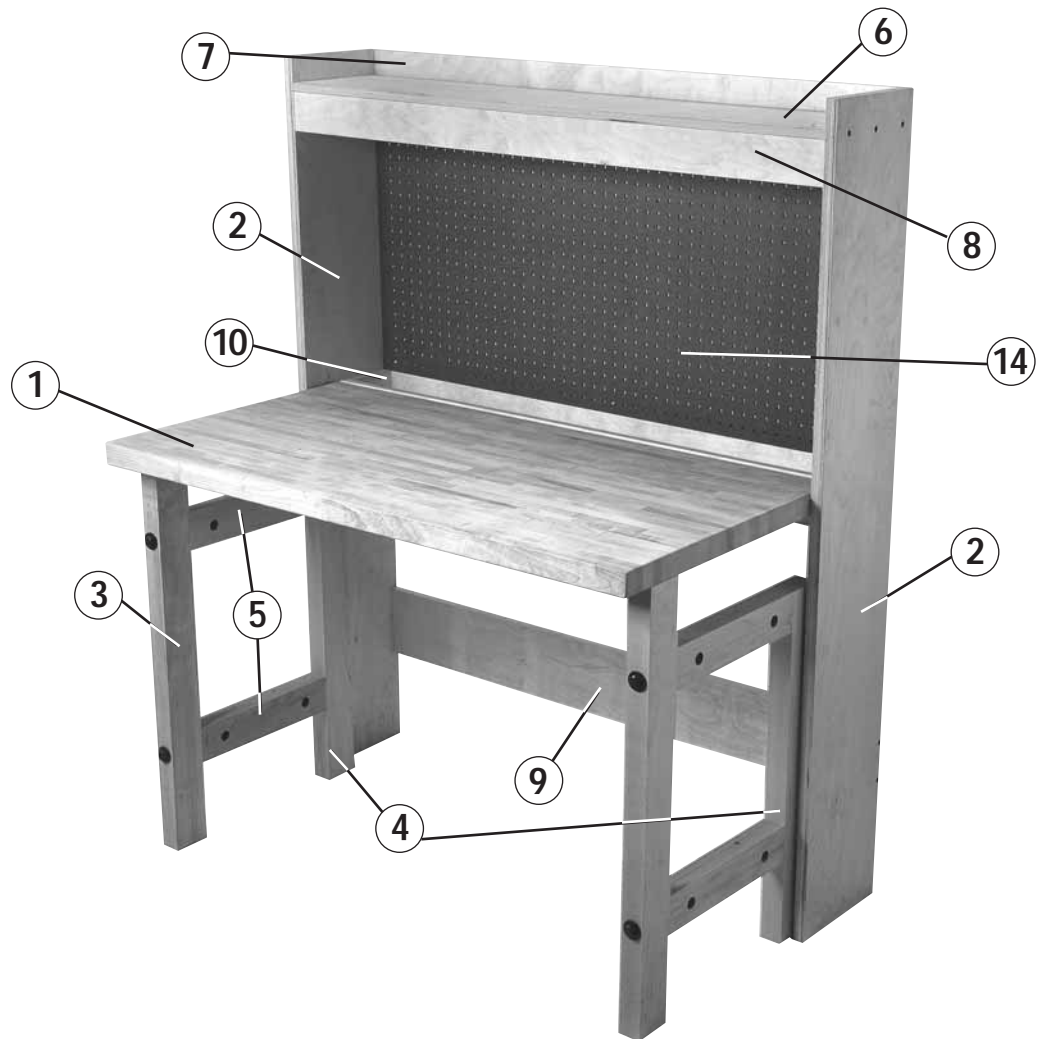

LH Pivot Hinge
(underside of Workbench Top)



PARTS LIST - FOLDING WORKBENCH

	W x L x T
1 Workbench Top (1)	24" x 47½" x 1¾"
2 Sides (2)	9⅞" x 60" x 1"
3 Front Legs (2)	3" x 32" x 1¾"
4 Back Legs (2)	3" x 27" x 1¾"
5 Leg Supports (4)	3" x 13⅜" x 1¾"
6 Top Shelf (1)	9⅞" x 48¼" x 3/4"
7 Top Back Support (1)	3¾" x 48" x 3/4"
8 Light Hood (1)	3⅞" x 48" x 3/4"
9 Bottom Back Support (1)	6" x 48¼" x 3/4"
10 Tray Ends (2)	3" x 4⅝" x 3/4"
11 Tray Front (1)	3⅞" x 48" x 3/4"
12 Tray Back (1)	4⅞" x 48" x 3/4"
13 Tray Bottom (1)	6" x 48" x 1/2"
14 Pegboard (1)	23⅜" x 48" x 1/4"
15 RH Pivot Hinge (1)	Not Shown
16 LH Pivot Hinge (1)	

17 3½" Hinge (2 pr.)	Not Shown
18 1/2-13 x 5½" Bolt (8)	Not Shown
19 1/2" USS Flatwasher (10)	Not Shown
20 2" Confirmat Screws (10)	Not Shown
21 Bullet Catch (2)	Not Shown
22 #8 x 1" Panhead Screw (14)	Not Shown
23 #6 x 1½" Flathead Wood Screw (28)	Not Shown

PARTS LIST - TOOLS NEEDED

- Drill
- Tri-Square
- Pencil
- Sanding Block
- Level
- Tape Measure
- Bevel Guage
- 12" "F" Style Clamps
- 60" Bar Clamp
- #2 Phillips Screwdriver
- Square Drive Screwdriver
- 3/16", 1/8", and 1/4" drill bits
- 4mm Allen Wrench or hex drive bit

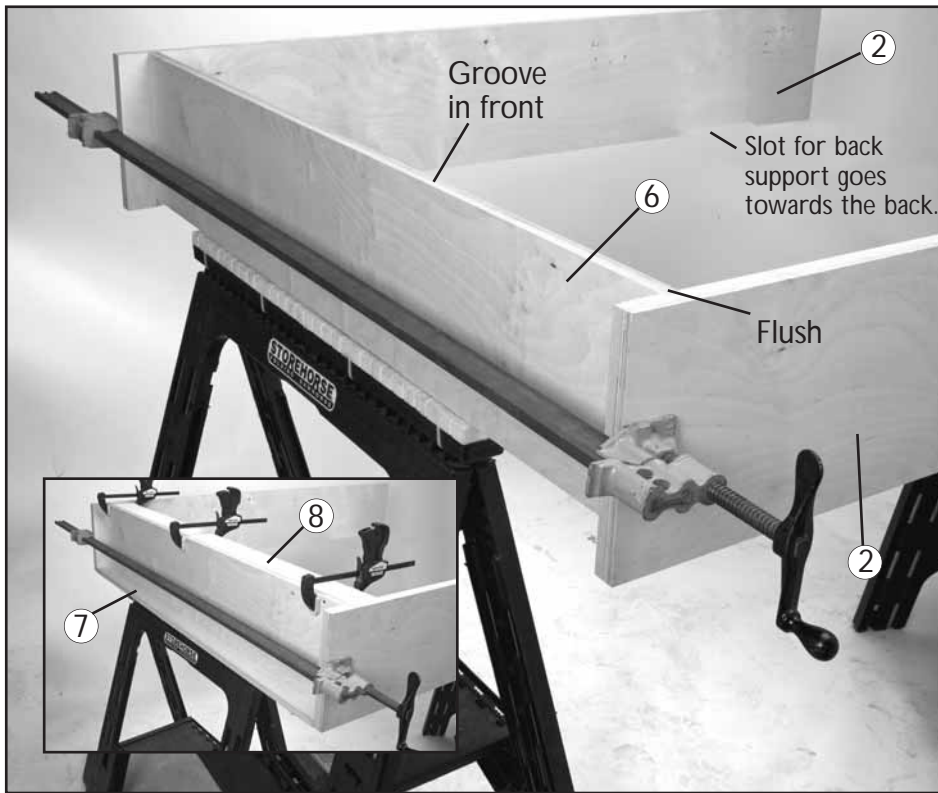

Fig. 1

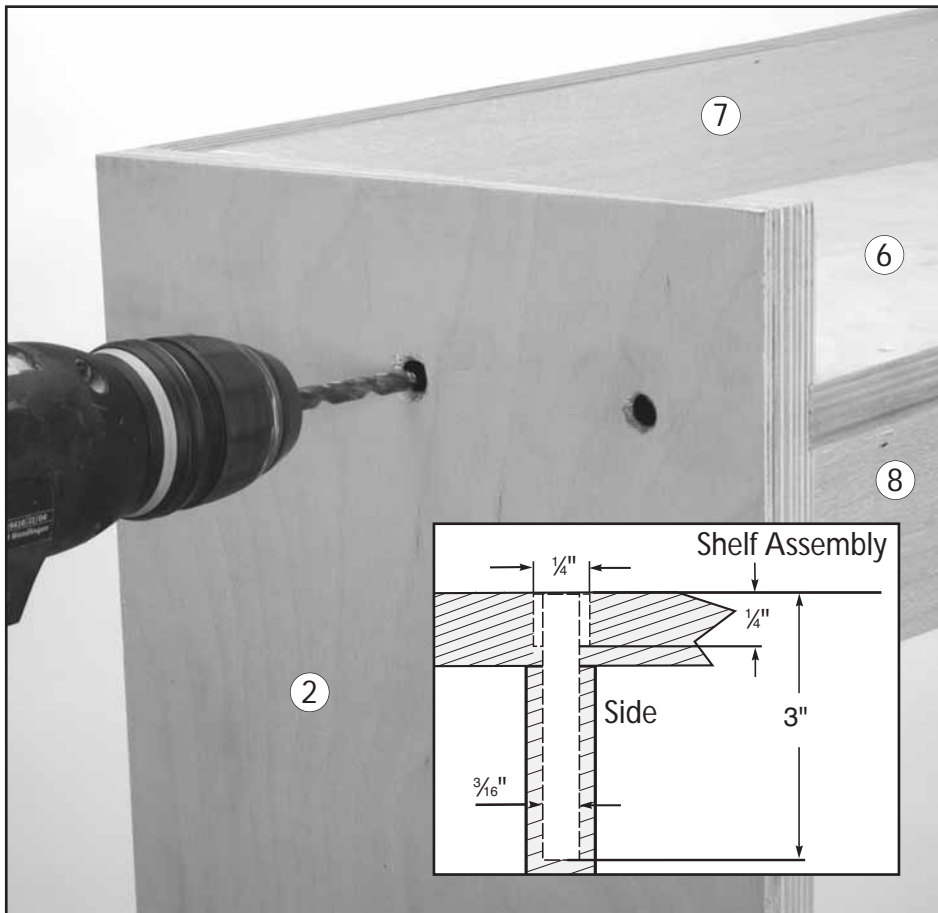

Fig. 2

Congratulations on purchasing the Rockler Folding Workbench! Please read through these instructions completely before starting assembly.

Making the Top Shelf

1. Fit the Top Shelf (6) into the dadoes towards the top of the two Sides (2). The groove running the length of the Top Shelf should be facing down and to the front. The front of the Top Shelf should be flush with the front edges of the two Sides. Use a clamp to hold the three pieces in place. Fig. 1.
2. Place the Top Back Support (7) in place, fitting the Top Shelf (6) into the groove running the length of the Top Back Support (7). It should be flush with the top and back edges of the two Sides (2).
3. Using the pre-drilled indicator holes as a guide, drill five 1/8" pilot holes through the Top Back Support (7) and into the Top Shelf (6).
4. Apply a thin layer of glue to the edge of the Top Shelf (6) and use five 1 1/2" Flathead Wood Screws (23) to screw the Top Back Support (7) in place.
5. Fit the Light Hood (8) into the groove running the length of the underside of the Top Shelf (6). Fig. 1 inset.
6. Using the pre-drilled indicator holes as a guide, drill three 1/8" pilot holes through the Top Shelf (6) and into the Light Hood (8).
7. Apply a thin layer of glue to the edge of the Light Hood (8) and use three 1 1/2" Flathead Wood Screws (23) to screw it in place. Fig. 1 inset.

At this point, you should have a completed top shelf assembly. Now, it's time to drill for the "stepped" confirmat screws that hold the Sides (2) to the Top Back Support (7) and Bottom Back Support (9). Start with the upper three indicator holes on each Side (see Fig 3). In each hole:

8. Use a 1/4" drill bit and drill only 1/4" deep.
9. Next, drill a 3/16" diameter hole, 3" deep. Fig. 2.
10. Place the Bottom Back Support (9) in the slots in the two Sides (2).

11. Repeat steps 8 through 10 for the two remaining indicator holes in both Sides. A cutaway of what you should have is shown in **Fig. 2 inset**.

12. Screw in the ten 2" Confirmat Screws (20).

Leg and Top Assembly

13. Assemble the Legs as shown in **Fig. 3**.

14. Using the pre-drilled pilot holes in the Legs as a guide, attach the 3½" Hinges (17) to the legs.

15. Attach the hinge and leg assemblies to the workbench Sides (2), again using pre-drilled pilot holes as a guide.

16. Insert the RH and LH Pivot Hinges (15 & 16) and washers into holes pre-drilled into the workbench Sides (2).

17. Pull out the Legs.

18. Center the Workbench Top (1) in position on top of the Legs and Pivot Hinges (15 & 16) making sure the hinge is flush with the table's edge.

19. Mark the location of the slotted screw holes only in both Pivot Hinges (15 & 16). **See Fig. 4**.

20. Remove the Workbench Top (1) and drill 1/8" pilot holes where you've marked. **See Fig. 4 inset**.

21. Put the Workbench Top (1) back in place on top of the Legs and Pivot Hinges.

22. Attach the Workbench Top to the Pivot Hinges (15 & 16) with 1" Pan Head Screws (22) in the hinges' slotted holes.

Note: Right now you are using only the slotted holes so the Workbench Top's position can be adjusted. You'll drill the rest of the pilot holes and attach the remaining screws after everything else is set.

Tray Assembly and Installation

23. Apply a thin layer of glue to the bottom edges of the Tray Front (11) and Tray Back (12). **See page 1**.

24. Fit them into the two grooves running the length of the Tray Bottom (13). Clamp the pieces in place.

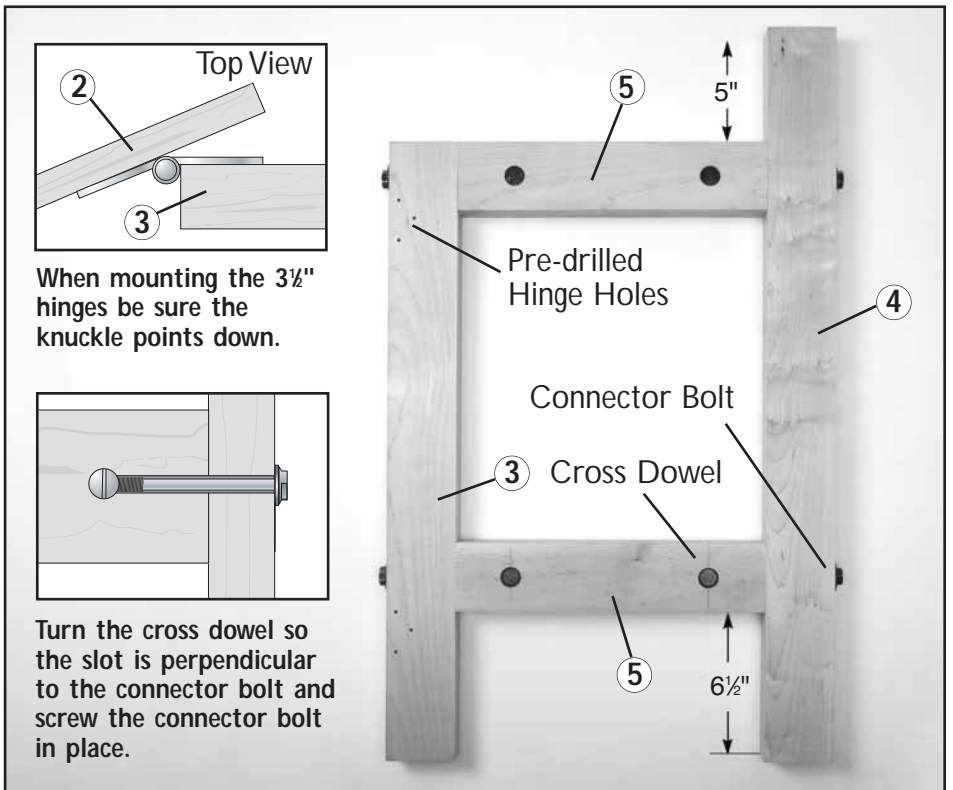

Fig. 3 - Right Leg Assembly.

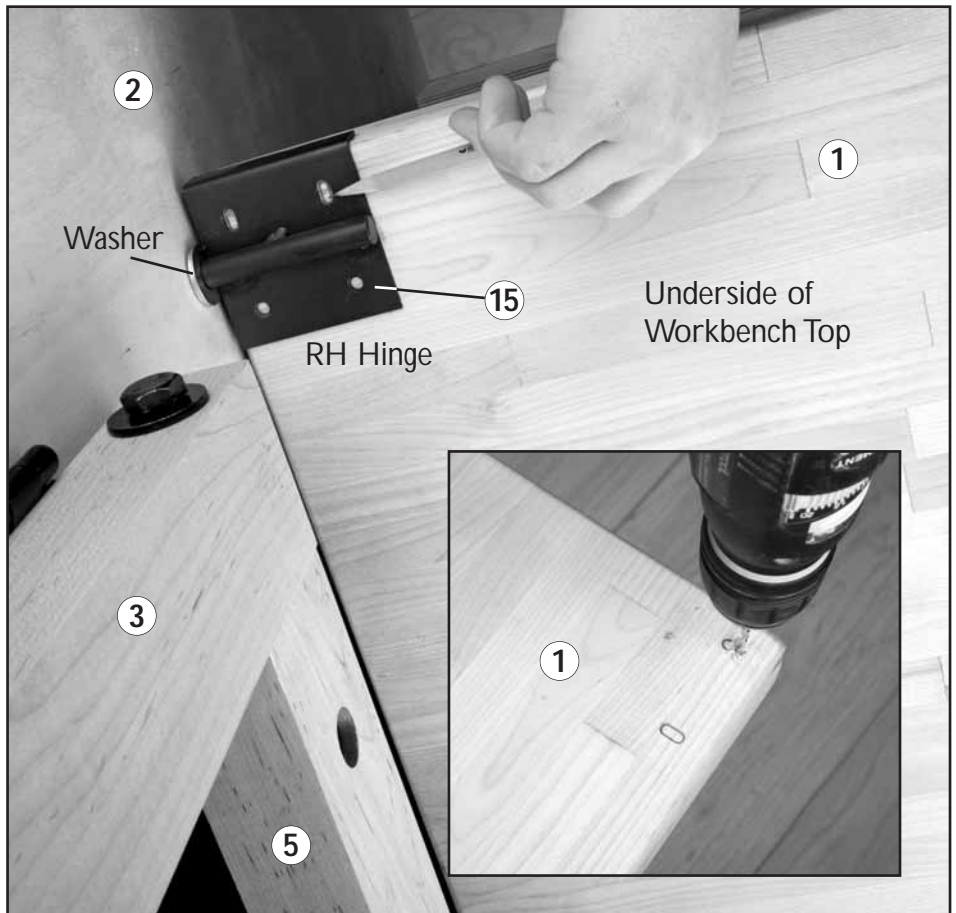

Fig. 4 - View from below the Workbench Top (1).

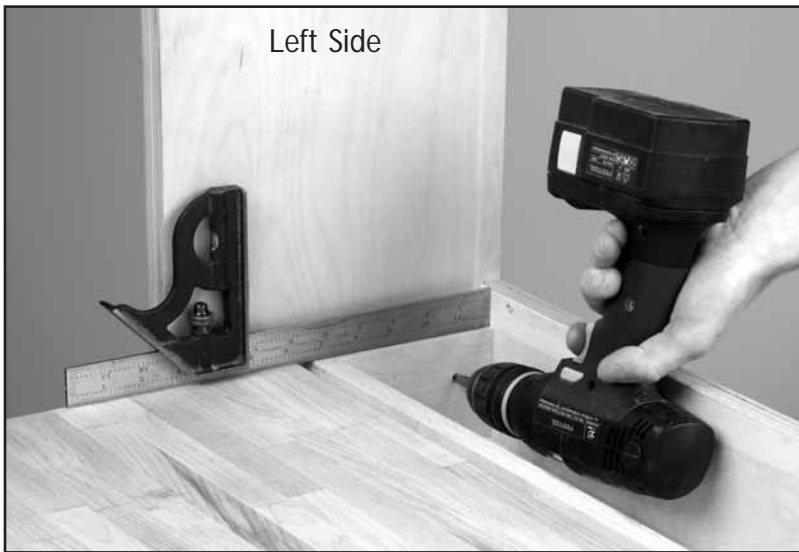

Fig. 5

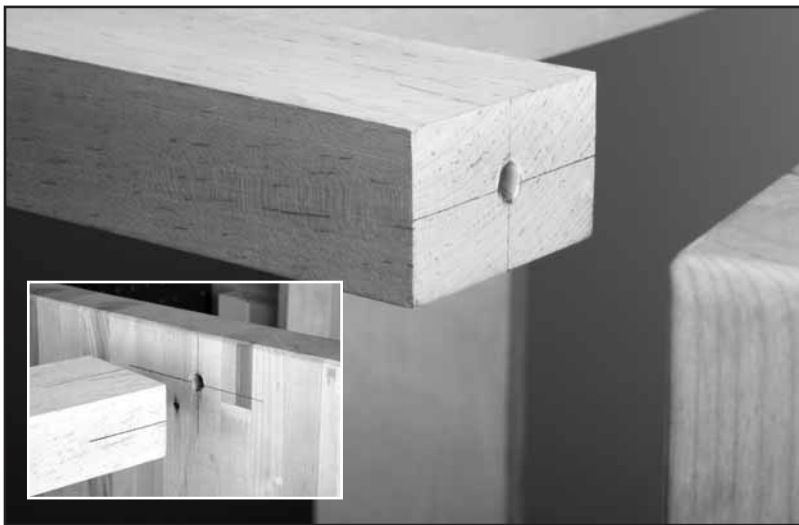

Fig. 6 - Bench tipped on side, showing alignment of benchtop and catch.



Fig. 7 - Use lag bolts for wall mounting (not included)

25. Using the pre-drilled indicator holes as a guide, drill ten 1/8" pilot holes through the Tray Bottom (14) and into the Tray Front (11) and Tray Back (12).
26. Fasten the pieces together with ten 1 1/2" Flathead Wood Screws (23).
27. Glue and screw the Tray Ends (11) in place in similar fashion to complete assembly.
28. Position the tray assembly in place, behind the Workbench Top (1) and flush with the back edges of the Sides (2), using a straight edge to ensure the correct height placement. **See Fig. 5.**
29. Once it is in place, drill 1/8" pilot holes and screw the tray assembly to the Sides (2) with two 1 1/2" Flathead Wood Screws (23) per side.

Final Assembly

30. Open and close the Workbench Top (1) and Legs, making sure that the top is working correctly. Adjust as needed.
31. Drill the remaining 1/8" pilot holes for the Pivot Hinges (15, 16) and insert 1" Panhead Screws (22).
32. Drill and insert the male ends of the bullet catches into 3/8" diameter holes 3/8" deep, centered on the top of the legs. **Fig. 6.**
33. Pull the legs out 90°.
34. Mark and drill 1/4" holes 1/2" deep in the under side of the Workbench Top for the female ends of the bullet catches. **Fig. 6 Inset.**
35. Sand and finish as needed. We recommend Maloof's Poly/Oil Finish (Rockler product #58644)

Mounting to the Wall

This unit must be secured to a wall stud or other structure in order to keep it from tipping and possibly causing physical harm. Use the mounting hardware and technique that is appropriate for your location and application.

36. Locate the Folding Workbench where you are going to use it.
37. Extend the legs.
38. Slide the Workbench up to wall and shim the back of the cabinet as needed.
39. Secure to the wall with chosen hardware and technique. Lag bolts or other heavy duty fasteners (not included) are recommended. **See Fig. 7.**
40. Attach the Pegboard (14) with the remaining 1" Panhead Screws (22).